

THIS INFORMATION IS CONFIDENTIAL AND IS DISCLOSED TO YOU ON CONDITION THAT NO FURTHER DISCLOSURE IS MADE BY YOU TO OTHER THAN TETULL PERSONNEL WITHOUT WRITTEN AUTHORIZATION FROM TETULL LTD.

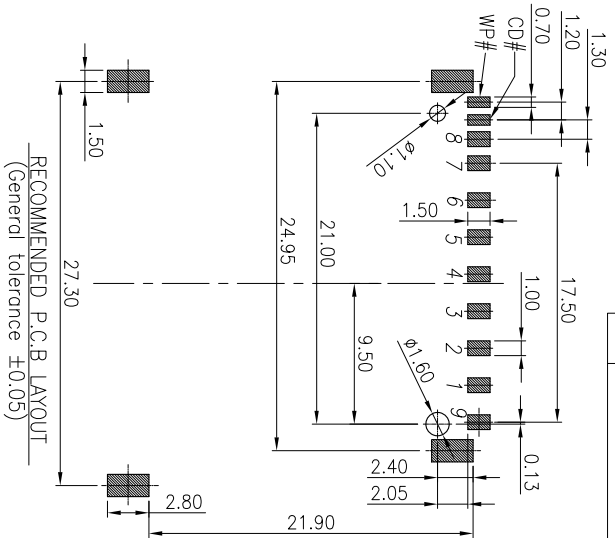

RECOMMENDED P.C.B LAYOUT
(General tolerance ±0.05)

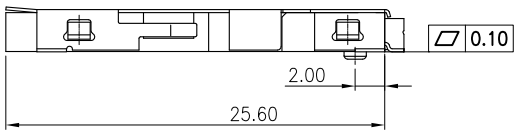
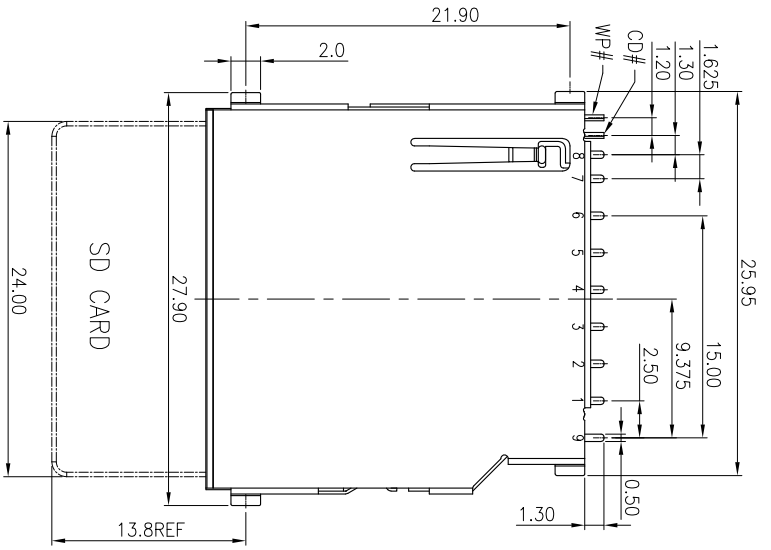
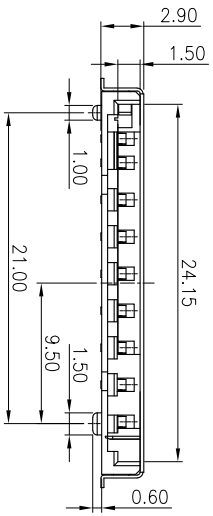

Pin#	Name	Type	Description
1	CD/DAT3	I/O/PP	Card Detect/Date Line [Bit3]
2	CMD	PP	Command/Response
3	Vss1	S	Supply voltage ground
4	VDD	S	Supply voltage
5	CLK	I	Clock
6	Vss2	S	Supply voltage ground
7	DAT0	I/O/PP	Date Line [Bit0]
8	DAT1	I/O/PP	Date Line [Bit1]
9	DAT2	I/O/PP	Date Line [Bit2]

SD CARD PIN DEFINE

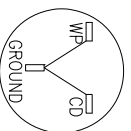
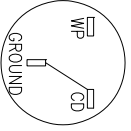
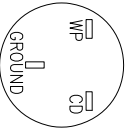

WITHOUT CARD
CARD INSERTED
WRITE PROTECT: LOCK
CARD INSERTED
WRITE PROTECT: UNLOCK

GND(SHELL) --- COMMON PIN

REV.	ECN NO	OR DESCRIPTION	REVISED	DATE
A	PRODUCT	RELEASE	JAMES	2012.02.23
B	MODIFY		BROKEN	2018.11.05

SPECIFICATIONS:
 MECHANICAL:
 CARD PUSH INSERTION/OUT FORCE: 1.0~3.0Kg
 DURABILITY: 5000 CYCLES
 ELECTRICAL:
 CURRENT RATING: 0.5A
 WITHSTANDING VOLTAGE: 500V AC R.M.S.
 CONTACT RESISTANCE: 100mΩ MAX
 INSULATION RESISTANCE: 1000M Ω MIN.
 ENVIRONMENTAL
 TEMPERATURE RANGE: -40°C ~ +85°C
 4.PACKING NUMBER: 50PCS/TRAY

NO	DESCRIPTION	QTY	MATERIAL	PLATING & COLOR
C	SHIELD	1	COPPER ALLOY 0.20t	NI PLATING
B	CONTACT	11	COPPER ALLOY 0.20t	Sold Finish On Contact Area Molte-Tin plated on Solder tail All over Nickel Plated.
A	HOUSING	1	THERMOPLASTIC UL94-V0	WHITE

UNLESS OTHERWISE SPECIFIED TOLERANCES

DECIMALS:	ANGLES:
X : ±0.5	X : ±2°
X.X : ±0.3	X.X : ±1°
X.XX : ±0.2	



TITLE:	SD CARD CONN NO PUSH
PART NO.	1081102A1003
DWN	BROKEN
CHKD	2018.11.05
APVD	
SCALE 1:1	UNIT: mm
SIZE: A4	SHEET: 10F1
CUSTOMER COPY	REV: B