

THIS INFORMATION IS CONFIDENTIAL AND IS DISCLOSED TO YOU ON CONDITION THAT NO FURTHER DISCLOSURE IS MADE BY YOU TO OTHER THAN TETULL PERSONNEL WITHOUT WRITTEN AUTHORIZATION FROM TETULL LTD.

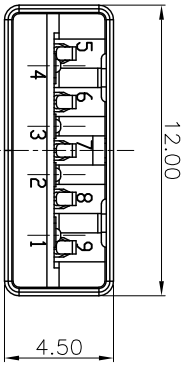

Pin NUMBER	SIGNAL NAME
1	VBUS
2	D-
3	D+
4	GND
5	StdA_SSRX-
6	StdA_SSRX+
7	GND_DRAIN
8	StdA_SSTX-
9	StdA_SSTX+

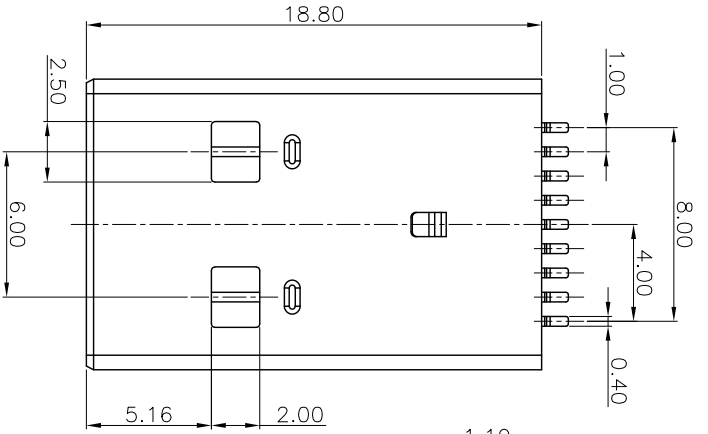
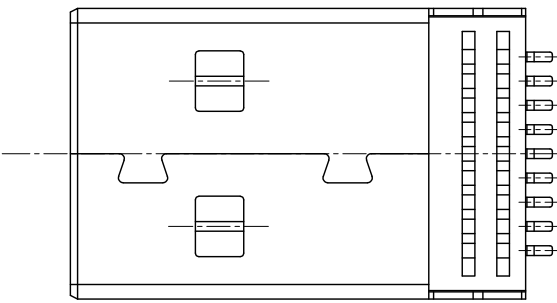
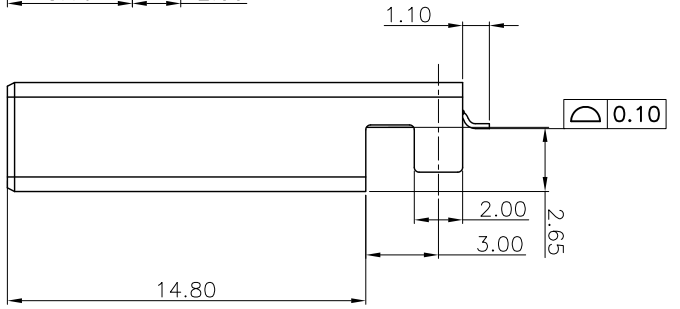

NOTE:

- ELECTRICAL CHARACTERISTICS
  - 1-1. VOLTAGE RATING: 30V MAX
  - 1-2. CURRENT RATING: 1.8A MAX
  - 1-3. CONTACT RESISTANCE: 30 milliohms MAX.
  - 1-4. INSULATION RESISTANCE: 1000 Megohms MIN.
  - 1-5. DIELECTRIC WITHSTANDING VOLTAGE: 500V AC FOR 1 MINUTE.
- MECHANICAL CHARACTERISTICS
  - 2-1. MATING FORCE: 35N MAX
  - 2-2. UNMATING FORCE: 10N MIN
  - 2-3. DURABILITY: 5000 CYCLES
  - 3. SALT SPRAY: 24H
- OPERATING TEMPERATURE: -40°C~85°C
- ROHS 2002/95/EC COMPLIANT.
- MPQ : 100PCS/TRAY.

RECOMMENDED PCB LAYOUT  
PCB TOP VIEW  
TOLERANCE: ±0.05mm

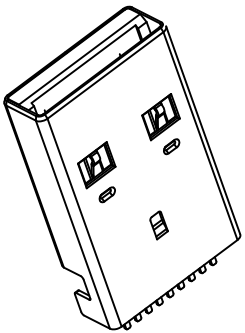
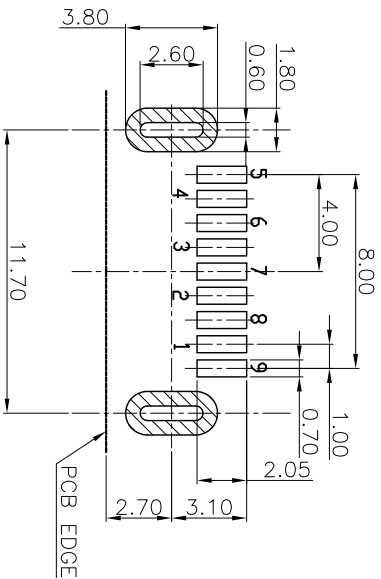

3D VIEW

TABLE:

P/N NO.	COLOR
10209014P001	COPPER ALLOY
10209014P007	SPCC

NO	DESCRIPTION	QTY	MATERIAL	PLATING & COLOR
C	SHELL	1	SEE TABLE	Ni PLATING
B	TERMINAL	9	COPPER ALLOY	Gold Flash On Contact Area Tin plated on Solder tail All over Nickel Plated.
A	HOUSING	1	LGP	BLUE

UNLESS OTHERWISE SPECIFIED TOLERANCES

DECIMALS:	ANGLES:
X : ±0.5	X : ±2°
X.X : ±0.3	X.X : ±1°
X.XX : ±0.2	

REV.	ECN NO.	OR DESCRIPTION	REVISED	DATE
B	MODIFY		BROKEN	2022.06.18
C	MODIFY		BROKEN	2023.03.22

TITLE: USB 3.0 9P 公头 SMT 沉板 2.65

PART NO. 10209014P001 & 007

DWN BROKEN 2023.03.22

CHKD

APVD

SCALE 1:1

UNIT: mm

SIZE: A4

SHEET: 10F1

REV. C

CUSTOMER COPY