

THIS INFORMATION IS CONFIDENTIAL AND IS DISCLOSED TO YOU ON CONDITION THAT NO FURTHER DISCLOSURE IS MADE BY YOU TO OTHER THAN TETULL PERSONNEL WITHOUT WRITTEN AUTHORIZATION FROM TETULL LTD.

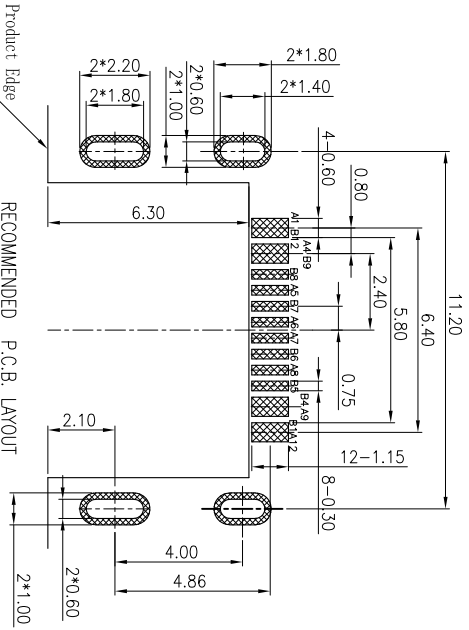
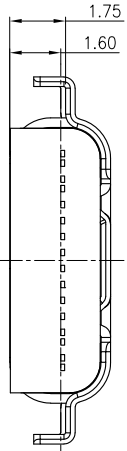
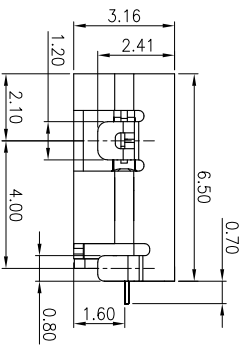
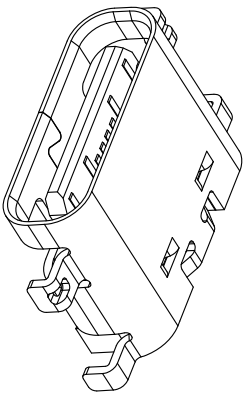
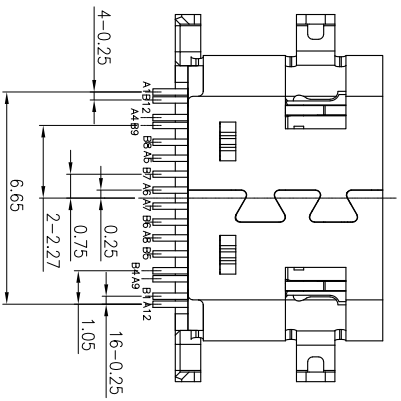
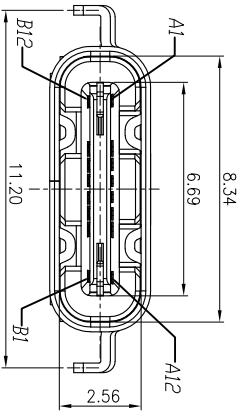
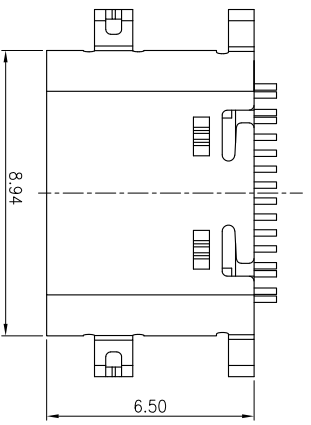

RECOMMENDED P.C.B. LAYOUT
TOLERANCE UNSPECIFIED ±0.05mm

REV.	ECN NO.	OR DESCRIPTION	REVISED	DATE
A		PRODUCT RELEASE	ARES	2016.03.29
B		MODIFY	BROKEN	2019.10.16

NOTE:

- ELECTRICAL CHARACTERISTICS
 - VOLTAGE RATING: 20V MAX
 - CURRENT RATING: 3.0A MAX
 - CONTACT RESISTANCE: 40 milliohms MAX.
 - INSULATION RESISTANCE: 100 Megohms MIN.
 - DIELECTRIC WITHSTANDING VOLTAGE: 100V AC FOR 1 MINUTE.
- MECHANICAL CHARACTERISTICS
 - MATING FORCE: 5~20N
 - UNMATING FORCE: 8~20N
 - DURABILITY: 10000 CYCLES
 - SALT SPRAY: 24H
 - OPERATING TEMPERATURE: -40C~85C
 - ROHS 2002 /95/EC COMPLIANT.
 - MPQ : 1500PCS/REEL.

A1	GND	B12	GND
A4	VBUS	B9	VBUS
A5	CC1	B8	SBU2
A6	DP1	B7	DN2
A7	DN1	B6	DP2
A8	SBU1	B5	CC2
A9	VBUS	B4	VBUS
A12	GND	B1	GND
PIN	SIGNAL NAME	PIN	SIGNAL NAME

D	SHELL	1	STAINLESS STEEL 0.30t	Ni PLATING
C	SHIELD	1	STAINLESS STEEL 0.12t	
B	CONTACT	16	COPPER ALLOY 0.12t	Gold Flash On Contact Area All over Nickel Plated .
A	HOUSING	1	THERMOPLASTIC U94-40	BLACK
NO	DESCRIPTION	QTY	MATERIAL	PLATING & COLOR

UNLESS OTHERWISE SPECIFIED TOLERANCES

DECIMALS: X :±0.5 X :±2°
X.X :±0.3 X.X :±1°
X.XX :±0.2

TETULL

CUSTOMER COPY

TETULL CORPORATION

PART NO. 1021605CR005
DWN BROKEN 2019.10.16

CHKD
APVD

SCALE 1:1 UNIT: mm

SIZE: A4 SHEET: 10F1 REV: B