

THIS INFORMATION IS CONFIDENTIAL AND IS DISCLOSED TO YOU ON CONDITION THAT NO FURTHER DISCLOSURE IS MADE BY YOU TO OTHER THAN TETULL PERSONNEL WITHOUT WRITTEN AUTHORIZATION FROM TETULL LTD.

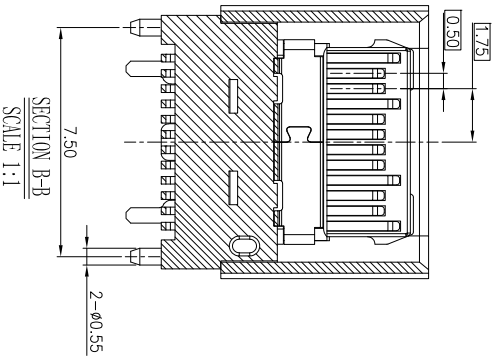
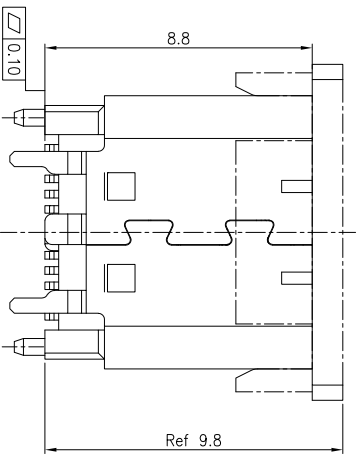
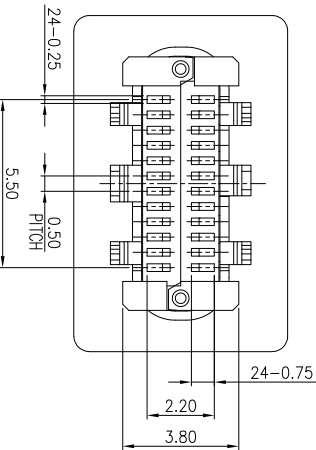
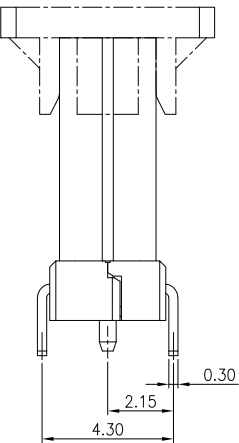
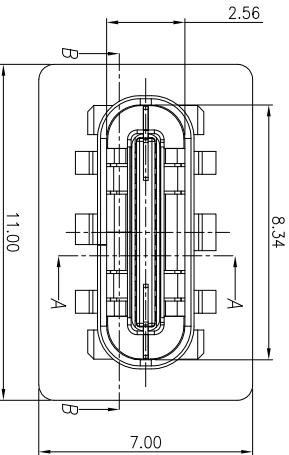
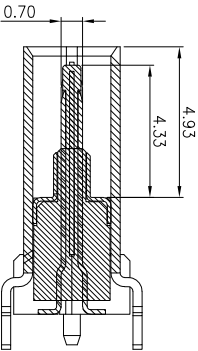
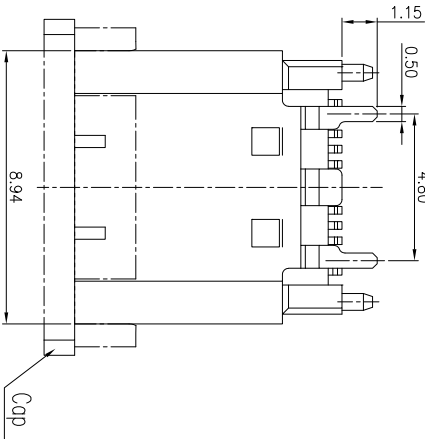

NOTE:

1. ELECTRICAL CHARACTERISTICS

- 1-1. VOLTAGE RATING: 20V MAX
- 1-2. CURRENT RATING: 5.0A MAX
- 1-3. CONTACT RESISTANCE: 40 milliohms MAX.
- 1-4. INSULATION RESISTANCE: 100 Megohms MIN.
- 1-5. DIELECTRIC WITHSTANDING VOLTAGE: 100V AC

FOR 1 MINUTE.

2. MECHANICAL CHARACTERISTICS

- 2-1. MATING FORCE: 5~20N
- 2-2. UNMATING FORCE: 8~20N
- 2-3. DURABILITY:10000 CYCLES
- 3. SALT SPRAY: 24H
- 4. OPERATING TEMPERATURE:-40°C~85°C
- 5. RoHS 2002/95/EC COMPLIANT.
- 6. MPQ : 450PCS/REEL.

F	CAP	1	HIGH TEMPERATURE PLASTIC U94-10	BLACK
E	SHELL	1	STAINLESS STEEL 0.30t	Ni PLATING
D	EMI	1	STAINLESS STEEL 0.12t	-----
C	SHIELD CONTACT	1	STAINLESS STEEL 0.12t	Ni PLATING
B	CONTACT	24	COPPER ALLOY 0.15t	3u" Au On Contact Area Gold Flush on Solder tail All over Nickel Plated .
A	HOUSING	1	HIGH TEMPERATURE PLASTIC U94-10	BLACK
NO	DESCRIPTION	QTY	MATERIAL	PLATING & COLOR
UNLESS OTHERWISE SPECIFIED TOLERANCES				
DECIMALS: ANGLES:				
X :±0.5 X :±2°				
X.X :±0.3 X.X :±1°				
X.XX :±0.2				
TITLE: USB TYPE C 24P TH SMT TYPE				
PART NO.		1022406K003		
DWG		BROKEN		
CHKD		2016.01.22		
APVD				
SCALE 1:1		UNIT: mm		
CUSTOMER COPY		SIZE: A4		SHEET: 10F2
		REV: B		

REV.	ECN NO OR DESCRIPTION	REVISED	DATE
A	PRODUCT RELEASE	JEMS	2016.01.22
B	MODIFY	BROKEN	2020.12.28

THIS INFORMATION IS CONFIDENTIAL AND IS DISCLOSED TO YOU ON CONDITION THAT NO FURTHER DISCLOSURE IS MADE BY YOU TO OTHER THAN TETULL PERSONNEL WITHOUT WRITTEN AUTHORIZATION FROM TETULL LTD.

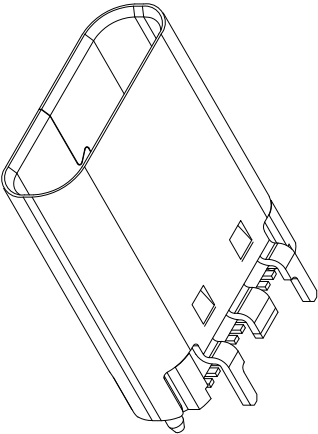

USB TYPE-C FULL-FEATURED RECEPTACLE INTERFACE PIN ASSIGNMENTS

PIN	Signal Name	Description	PIN	Signal Name	Description
A1	GND	Ground return	B12	GND	Ground return
A2	SSTxp1	Positive half of first SuperSpeed TX differential pair	B11	SSRxp1	Positive half of first SuperSpeed RX differential pair
A3	SSTxn1	Negative half of first SuperSpeed TX differential pair	B10	SSRxn1	Negative half of first SuperSpeed RX differential pair
A4	Vbus	Bus Power	B9	VBUS	Bus Power
A5	CC1	Configuration Channel	B8	SBU2	Sideband Use(SBU) Channel
A6	Dp1	Positive half of the USB 2.0 differential pair-Position 1	B7	Dn2	Positive half of the USB 2.0 differential pair-Position 2
A7	Dn1	Negative half of the USB 2.0 differential pair-Position 1	B6	Dp2	Negative half of the USB 2.0 differential pair-Position 2
A8	SBU1	Sideband Use(SBU) Channel	B5	CC2	Configuration Channel
A9	VBUS	Bus Power	B4	VBUS	Bus Power
A10	SSRxnp2	Negative half of second SuperSpeed RX differential pair	B3	SSTxnp2	Negative half of second SuperSpeed TX differential pair
A11	SSRxnp2	Positive half of second SuperSpeed RX differential pair	B2	SSTxnp2	Positive half of second SuperSpeed TX differential pair
A12	GND	Ground return	B1	GND	Ground return

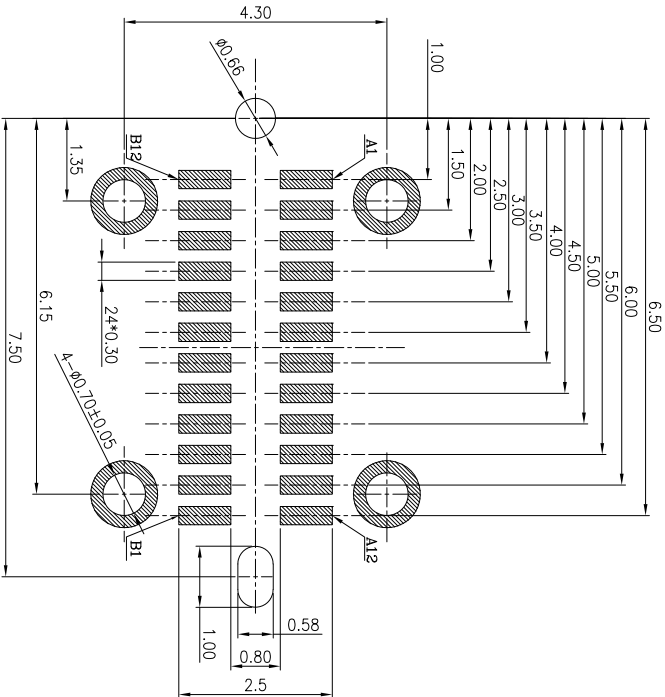

RECOMMENDED P.C.B. LAYOUT (T:1.00mm)  
TOLERANCE UNSPECIFIED ±0.05mm

REV.	ECN NO OR DESCRIPTION	REVISED	DATE
A	PRODUCT RELEASE	JAMES	2016.01.22
B	MODIFY	BROKEN	2020.12.28

F	CAP	1	HIGH TEMPERATURE PLASTIC U194-V0	BLACK
E	SHELL	1	STAINLESS STEEL 0.30t	Ni PLATING
D	EMI	1	STAINLESS STEEL 0.12t	-----
C	SHIELD CONTACT	1	STAINLESS STEEL 0.12t	Ni PLATING
B	CONTACT	24	COPPER ALLOY 0.15t	3u" Au On Contact Area Gold Flash on Solder tail All over Nickel Plated
A	HOUSING	1	HIGH TEMPERATURE PLASTIC U194-V0	BLACK
NO	DESCRIPTION	QTY	MATERIAL	PLATING & COLOR
UNLESS OTHERWISE SPECIFIED TOLERANCES				
DECIMALS: ANGLES:				
X :±0.5 X :±2°				
X.X :±0.3 X.X :±1°				
X.XX :±0.2				
TITLE: USB TYPE C 24P TH SMT TYPE				
PART NO.		1022406XR003		
DWG		BROKEN		
CHKD		2016.01.22		
APVD				
SCALE 1:1		UNIT: mm		
CUSTOMER COPY		SIZE: A4 SHEET: 2072 REV: B		

